



**NUMBER:** 08-030-04

**GROUP:** Electrical

**DATE:** September 2, 2004

*This bulletin is supplied as technical information only and is not an authorization for repair. No part of this publication may be reproduced, stored in a retrieval system, or transmitted, in any form or by any means, electronic, mechanical, photocopying, or otherwise, without written permission of DaimlerChrysler Corporation.*

**THIS BULLETIN IS BEING PROVIDED IN ADVANCE. DO NOT ORDER PARTS UNTIL SEPTEMBER 7, 2004.**

**SUBJECT:**

One Or Both Keyless Entry Transmitters Do Not Work

**OVERVIEW:**

This bulletin involves replacing or reworking the red panic button on the transmitter.

**MODELS:**

2004 - 2005 (ZH) Crossfire Coupe/Crossfire Roadster

**SYMPTOM/CONDITION:**

The vehicle operator may describe that the keyless entry transmitter is not working after the batteries in the transmitter were replaced.

The red panic button on the transmitter may stick causing a drain on the transmitter batteries.

**DIAGNOSIS:**

Verify that the keyless entry transmitter does not lock or unlock the vehicle and the panic function does not operate.

If the customer describes and the technician verifies the Symptom/Condition, perform the Repair Procedure.

**PARTS REQUIRED:**

Qty.	Part No.	Description
1	05170599AA	Button, Panic
AR (2)	05103687AA	Battery, Transmitter

**REPAIR PROCEDURE:**

1. Test the batteries in the transmitter. The batteries in the transmitter can be tested by pressing and holding both the lock and unlock buttons simultaneously for more than one second. The batteries are charged sufficiently if the LED next to the ignition key blade lights up briefly.

**CAUTION:** In the next step, be careful to use the correct specified part number batteries in the transmitter. Using incorrect batteries will damage the circuitry within the transmitter.

2. If the batteries do not light the LED, check to insure the batteries, p/n 05103687AA, are the correct specified batteries for the transmitter. Replace the batteries as necessary.

**NOTE:** If the transmitter does not have the correct specified batteries installed, the transmitter must be replaced.

3. Place a small jeweler's type screwdriver along side the red panic button and pry up to remove the button from the transmitter ([Fig. 1](#)).

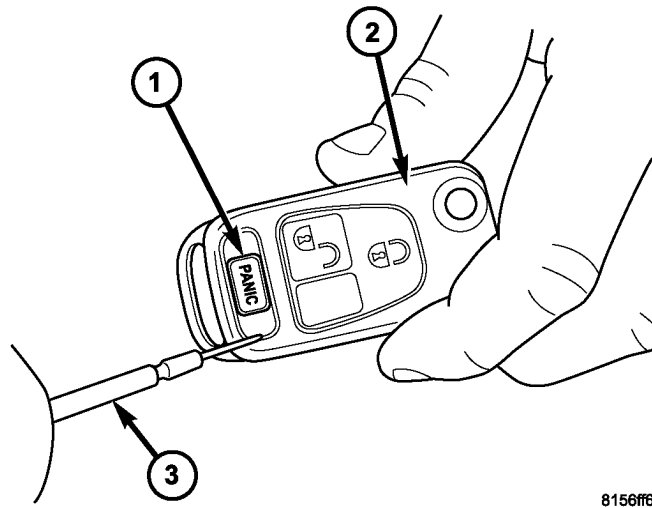

8156ff6e

**Fig. 1 REMOVING THE RED PANIC BUTTON**

- 1 - RED PANIC BUTTON
- 2 - TRANSMITTER
- 3 - SMALL SCREWDRIVER

- 
4. If a new panic button, p/n 05170599AA, is available, proceed to [Step #6](#). If not, proceed to [Step #5](#)
  5. Inspect the stem on the bottom side of the red panic button. If there is a burr on the stem of the button, remove the burr using a suitable sharp cutter ([Fig. 2](#)). Insert the reworked red panic button into the transmitter by pressing one side of the button into the transmitter housing and then pressing the other side of the button into the transmitter housing ([Fig. 3](#)). When the button is securely in the transmitter, proceed to [Step #7](#).

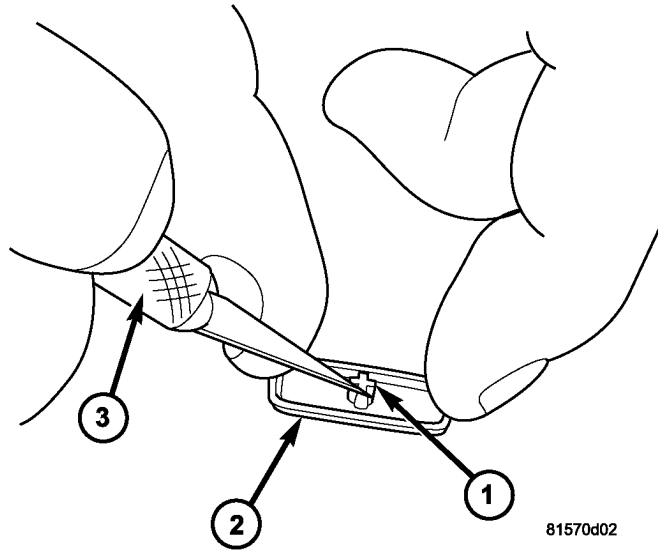

**Fig. 2 REMOVING BURR ON PANIC BUTTON**

- 1 - BURR ON STUD
  - 2 - PANIC BUTTON
  - 3 - KNIFE USED FOR TRIMMING BURR
- 

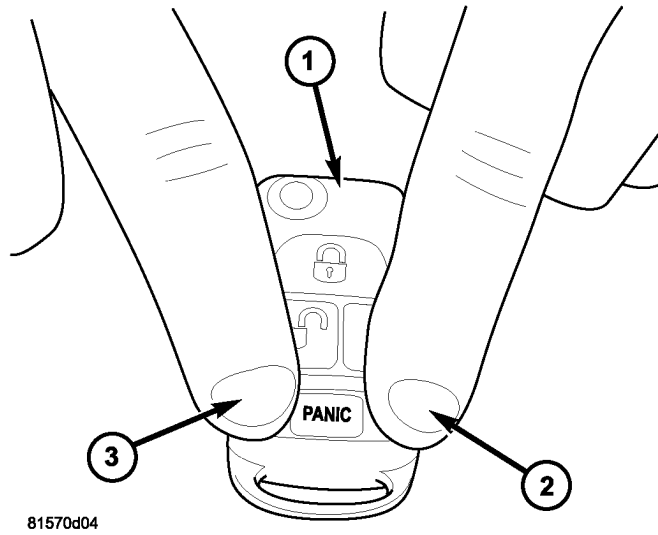

**Fig. 3 INSTALLING THE RED PANIC BUTTON**

- 1 - TRANSMITTER
  - 2 - PRESS DOWN AND HOLD ONE SIDE
  - 3 - PRESS DOWN THE OTHER SIDE
-

6. Insert a new red panic button, p/n 05170599AA, into the transmitter by pressing one side of the button into the transmitter housing and then the other side of the button into the transmitter housing (Fig. 3). When the button is securely in the transmitter, proceed to [Step #7](#).
7. Test the transmitter to be sure the transmitter is operational.

**POLICY:**

Reimbursable within the provisions of the warranty.

**TIME ALLOWANCE:**

Labor Operation No:	Description	Amount
08-80-28-92	Transmitter, Repair or Replace	0.2 Hrs.

**FAILURE CODE:**

AM	Authorized Modification
----	-------------------------